

## Saving data, graphs, and methods

- 1** Before measurement, to turn on the auto save option, touch the Auto Save option box during the method set up. Select your "save to" location.

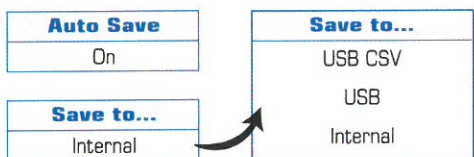

- 2** After measurement, to save data, touch the Open Options icon, then touch the Save Data icon.

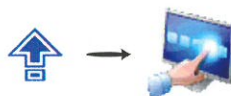

- 3** To view a graph (if available), touch the Open Options icon, then touch the View Scan icon. To return to previous view, touch the View Scan icon again.

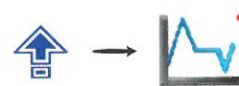

- 4** To save the graph to a USB drive as a .BMP file, touch the Screen Capture icon in the upper left corner of the screen.



- 5** To save a method for future use, touch the Open Options Icon, then touch the Save Method icon.

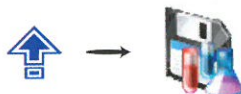

- 6** To select where to save your method (folders or USB), touch the Folder box. To give the method a unique name, touch the Method Name box.



## Cleaning and Care

If you change sample types, clean the sample port with ddH<sub>2</sub>O, then reference with new reference solution.





- ▶ Use a lint-free tissue or cloth to clean the sample port
- ▶ Sample can also be aspirated from the port using a pipette
- ▶ Do not autoclave
- ▶ Do not use abrasive cleaners
- ▶ Do not use corrosive materials such as sodium hydroxide or hydrochloric acid

### Pipetting Tips

- ▶ Pipette as little as 0.5 µL of sample. For the best results, pipette 2 µL into the sample port.
- ▶ The sample or reference should be pipetted into the center of the sample port.
- ▶ The sample or reference should be in contact with both probes.

### Saving Tips

- ▶ The USB CSV or USB saving options will not appear unless a USB drive has been inserted into the QuickDrop Spectrophotometer.
- ▶ Selecting USB will save data in .bat format, which may only be opened on a QuickDrop Spectrophotometer.
- ▶ Data saved to USB CSV may be opened with any spreadsheet software.
- ▶ Data saved or auto saved to USB CSV will not include graphs. Graphs must be saved separately using the Screen Capture icon. 
- ▶ The internal storage will hold up to 100 data files.
- ▶ Internally saved data may be accessed by touching the Sample Manager icon. 
- ▶ Each of the nine Method folders will save up to nine methods.

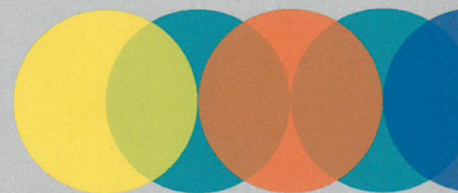

# QUICKSTART GUIDE

Using the QuickDrop™ Spectrophotometer micro-volume sample port to take a measurement



**1** Select desired method from the following Life Science menu options

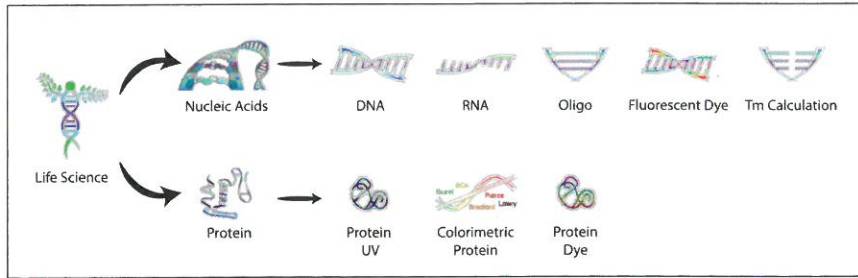

**2** Customize method by touching each option box

<b>Pathlength</b> 0.5 mm (drop)	<b>Sample</b>
<b>Dilution Factor</b> 1.000	<b>Units</b> µg/mL
<b>Background</b> On	<b>Factor</b> 50.00

**3** Set Pathlength to 0.5 mm.

Pathlength
10 mm [cuvette]
5 mm [cuvette <sup>s</sup> ]
2 mm [cuvette <sup>s</sup> ]
1 mm [cuvette <sup>s</sup> ]
0.5 mm [drop]

**4** Inspect the sample port to ensure that it is clean.



**5** If not, add a drop of distilled water and wipe away with a dry, lint-free tissue.



**6** Pipette the reference into the sample port. See pipetting tips on reverse.

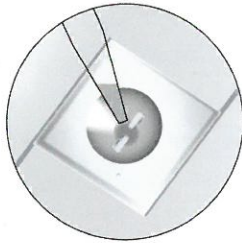

**7** Touch the Reference Measurement icon.



**8** Use a dry lint-free tissue to wipe the sample port clean.



**9** Pipette sample into the sample port. See pipetting tips on reverse.

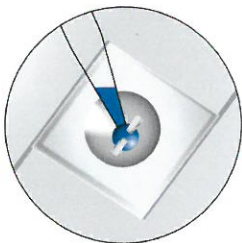

**10** Touch the Sample Measurement icon.



Continue reading samples by repeating steps 8-10. When finished, clean sample port according to directions on reverse. ➔

To download the full user guide, please visit [moleculardevices.com/quickdropmanual](http://moleculardevices.com/quickdropmanual)

To view videos, or additional resources, please visit [moleculardevices.com/quickdrop](http://moleculardevices.com/quickdrop)